



House 'To Let'

£1,150 PCM

North Road, Thornbury



KEY FEATURES

Mid Terraced House - Close to Local Amenities - Lounge - Fitted Kitchen - Two Bedrooms - Bathroom suite With Shower Over Bath - Rear Garden - Double Glazing - Allocated Off Street Parking - Gas Central Heating - Unfurnished.

EPC - [[EPCImages.EERImage.CurrentAsLetter]] - DEPOSIT £1326.00

Description

A well-presented two-bedroom terraced house, ideally located within walking distance of Thornbury town centre and local amenities. The property is currently undergoing redecoration throughout and will benefit from newly fitted carpets prior to occupancy. Offered on an unfurnished basis, the accommodation comprises an entrance hallway, a modern kitchen equipped with an electric oven, gas hob, washing machine, and fridge/freezer, and a spacious lounge with French doors leading to an enclosed rear garden. Upstairs, there are two well-proportioned bedrooms and a bathroom fitted with a WC, wash hand basin, and a bath with shower over. Further benefits include gas central heating, double glazing throughout, a private rear garden and allocated parking for one vehicle. Ideal for a couple or small family. Non smokers only. Available now.



Situation

Thornbury is a thriving market town to the north of the City of Bristol and the M4/M5 interchange, with excellent commuting links via the motorway network and by rail from Bristol Parkway Station (Paddington/South Wales). The pedestrianised High Street offers a wide variety of shops, cafes, pubs and restaurants. Other facilities include the leisure centre, golf course and library, plus open community spaces, parks and sports grounds/clubs. The town is blessed with a number of primary and junior schools, plus The Castle secondary school (www.thecastleschool.org.uk) which is situated close to Thornbury's Tudor Castle, a luxury hotel.



Local Authority & Council Tax

South Gloucestershire Council
Council Tax Band - C



Contact & Viewing

T: 01454 417336
w: www.milburys.co.uk



Floorplan



Additional Photos

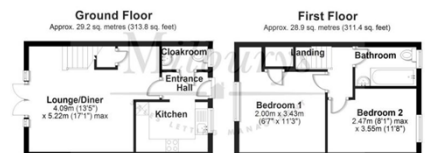

Important Notice

Milburys Estate Agents Ltd, their clients and any joint agents give notice that they have not tested any apparatus, equipment, fixtures, fittings, heating systems, drains or services and so cannot verify they are in working order or fit for their purpose. Interested parties are advised to obtain verification from their surveyor or relevant contractor. Statements pertaining to tenure are also given in good faith and should be verified by your legal representative. Digital images may, on occasion, include the use of a wide-angle lens. Please ask if you have any queries about any of the images shown, prior to viewing. Where provided, floor plans are shown purely as an indication of layout. They are not scale drawings and should not be treated as such. Complete listings and full details of all our properties (both for sale and to let) are available at www.milburys.co.uk