



Maisonette 'To Let'
£950 PCM
Oakleaze Road, Thornbury



KEY FEATURES

Two/Three Bedroom - Maisonette - Newly Renovated - Modern Kitchen & Bathroom - Rear Communal Terrace - Electric Heating - UPVC Double Glazing - On Road Parking - Unfurnished - (EPC - E)
EPC - E - DEPOSIT £1096.00

Description

An unfurnished two/three bedroom maisonette close to Thornbury town centre. The apartment has recently undergone a complete refurbishment and is offered on an unfurnished basis. The spacious accommodation comprises a kitchen with cooker, washer/dryer & built in dishwasher, lounge, three bedrooms, two of which are double, bedroom 3/study room and a white bathroom suite with shower over bath and storage cupboard. The property benefits further from UPVC double glazing replaced in 2024, electric heating and access to the rear outside roof terrace. Would suit a couple or small family, non smokers only. Available now for six months to long term.



Situation

Thornbury is a thriving market town to the north of the City of Bristol and the M4/M5 interchange, with excellent commuting links via the motorway network and by rail from Bristol Parkway Station (Paddington/South Wales). The High Street offers a wide variety of shops, cafes, pubs and restaurants. Other facilities include the leisure centre, golf course and library, plus open community spaces, parks and sports grounds/clubs. The town is blessed with a number of primary and junior schools, plus The Castle secondary school (www.castle.gloucs.sch.uk) which is situated on the edge of open countryside close to Thornbury's Tudor Castle, now a luxury hotel.



Local Authority & Council Tax

South Gloucestershire Council
Council Tax Band - B



Contact & Viewing

T: 01454 417336
w: www.milburys.co.uk



Floorplan

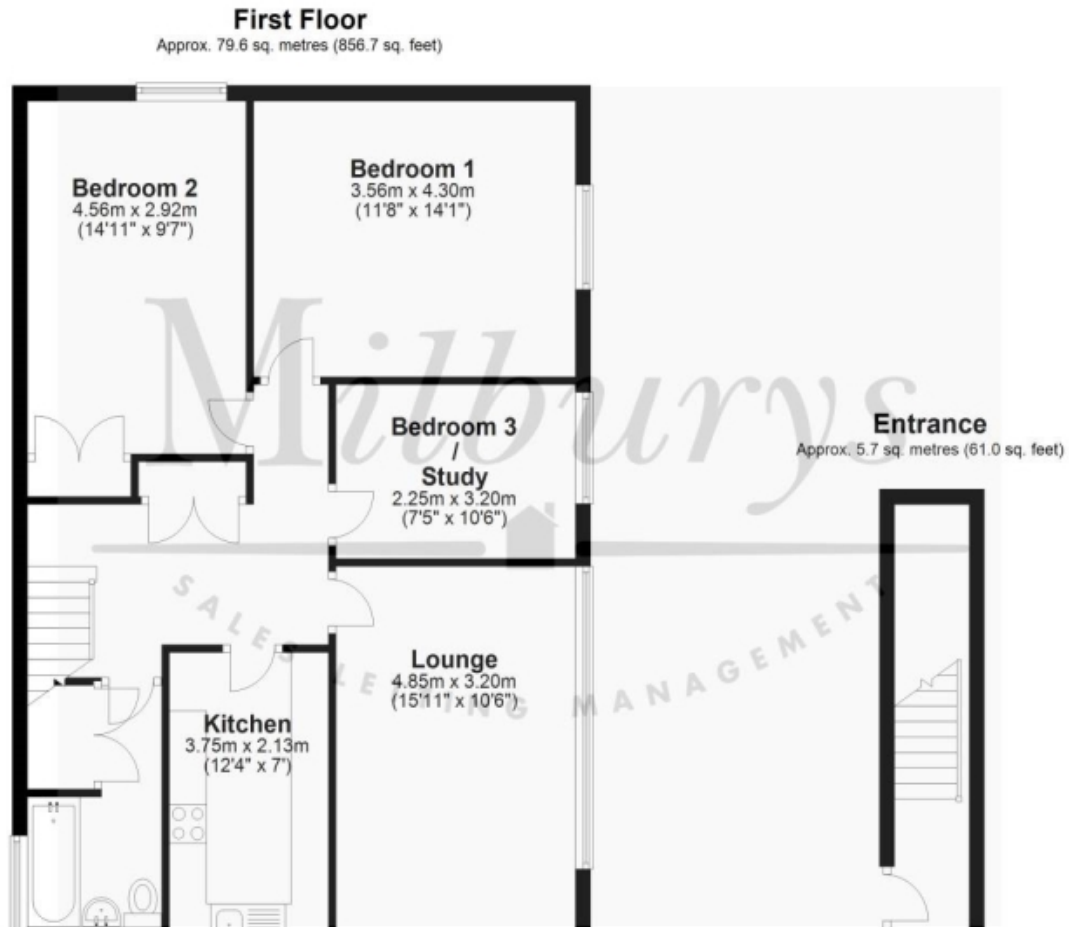

Additional Photos

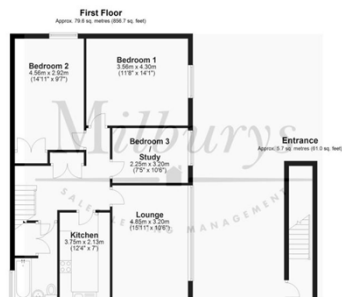

Important Notice

Milburys Estate Agents Ltd, their clients and any joint agents give notice that they have not tested any apparatus, equipment, fixtures, fittings, heating systems, drains or services and so cannot verify they are in working order or fit for their purpose. Interested parties are advised to obtain verification from their surveyor or relevant contractor. Statements pertaining to tenure are also given in good faith and should be verified by your legal representative. Digital images may, on occasion, include the use of a wide-angle lens. Please ask if you have any queries about any of the images shown, prior to viewing. Where provided, floor plans are shown purely as an indication of layout. They are not scale drawings and should not be treated as such. Complete listings and full details of all our properties (both for sale and to let) are available at www.milburys.co.uk