



House 'To Let'

£1,295 PCM

The Entrance Lodge, Eastwood Park



KEY FEATURES

19th Century Entrance Lodge - Lounge - Kitchen - Utility Room, Cloakroom - Two Bedroom - Bathroom with Separate Shower Cubicle - Detached - Off Road Parking for 2/3 Cars - Garden - LPG Central Heating - Double Glazing

EPC - [[EPCImages.EERImage.CurrentAsLetter]] - DEPOSIT £1494.00

Description

This 19th-century entrance lodge, originally part of a grand country estate, beautifully combines period character with practical living. Offered unfurnished, the property features a lounge, kitchen equipped with an electric oven and hob, and space for an under-counter fridge. A separate pantry, cloakroom, and utility room provide ample storage and convenience. Upstairs, there are two double bedrooms and a modern bathroom suite with a separate shower cubicle. The home benefits from LPG central heating and double glazing throughout. Externally, the property includes off-road parking for two to three vehicles and a generously sized garden that backs onto woodland and open countryside. Available now.



Situation

The village of Falfield is situated just to the west of junction 14 of the M5 ideal for commuting to Gloucester to the north and Bristol to the south. There are nearby primary schools in Stone and Tortworth and secondary schools include The Castle School in Thornbury and Katharine Lady Berkeley's in Kingswood, Gloucestershire. Falfield benefits from a village post office and general stores, public house and church. A more extensive range of shopping and leisure facilities can be found in Thornbury approximately 4 miles to the south.



Local Authority & Council Tax

South Gloucestershire Council
Council Tax Band -



Contact & Viewing

T: 01454 417336
w: www.milburys.co.uk



Floorplan

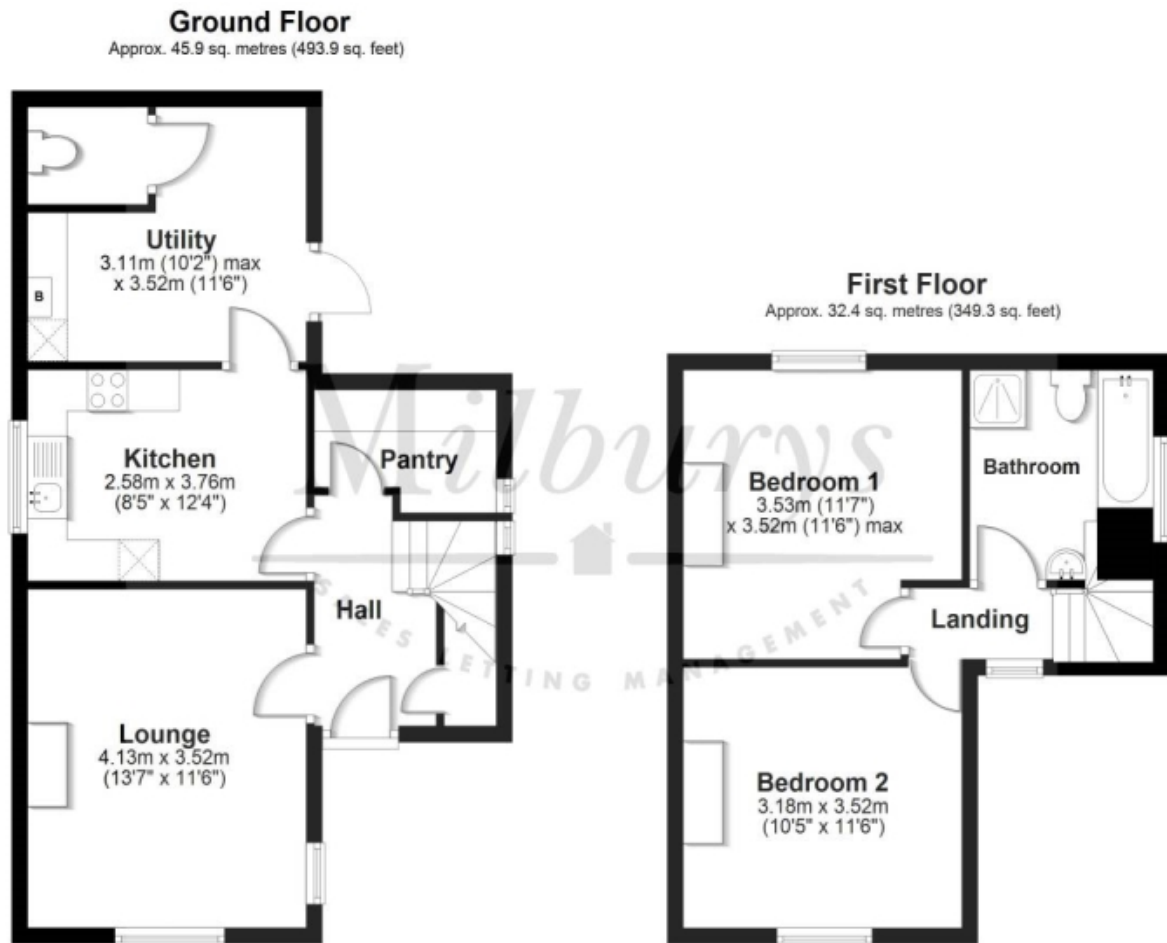

Additional Photos



Important Notice

Milburys Estate Agents Ltd, their clients and any joint agents give notice that they have not tested any apparatus, equipment, fixtures, fittings, heating systems, drains or services and so cannot verify they are in working order or fit for their purpose. Interested parties are advised to obtain verification from their surveyor or relevant contractor. Statements pertaining to tenure are also given in good faith and should be verified by your legal representative. Digital images may, on occasion, include the use of a wide-angle lens. Please ask if you have any queries about any of the images shown, prior to viewing. Where provided, floor plans are shown purely as an indication of layout. They are not scale drawings and should not be treated as such. Complete listings and full details of all our properties (both for sale and to let) are available at www.milburys.co.uk